

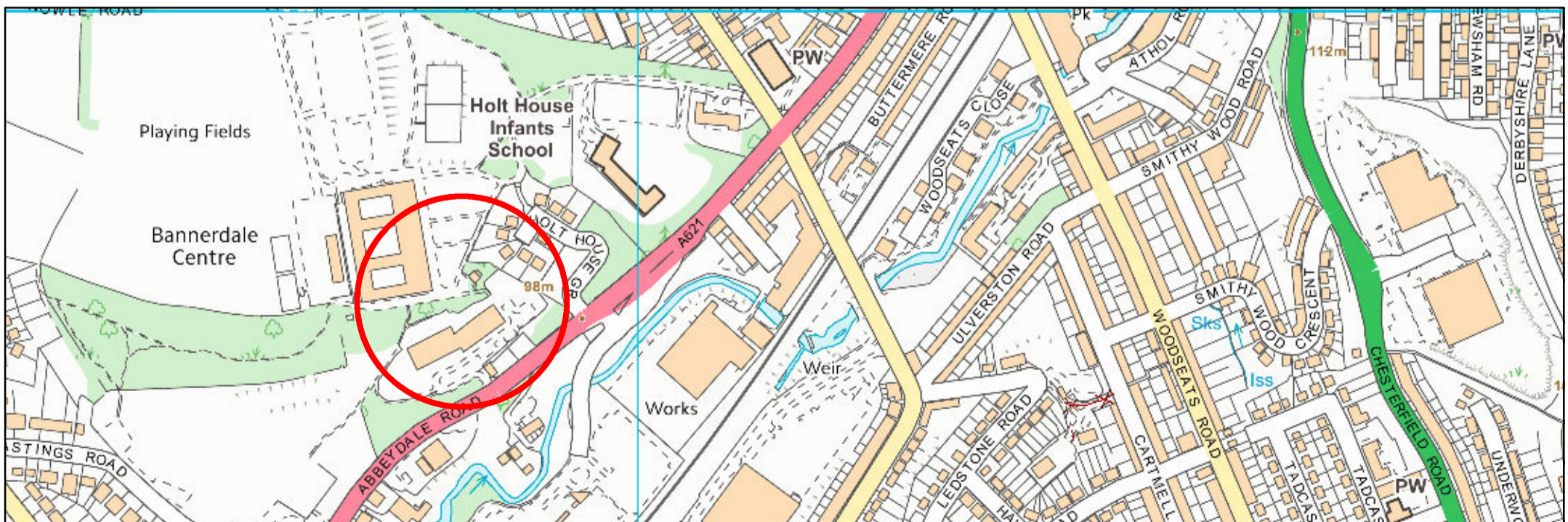

Highway Records  
Highway Maintenance Division  
Culture and Environment  
Howden House  
Union Street  
Sheffield  
S1 2SH

# TOWN AND COUNTRY PLANNING ACT 1990 SECTION 257 PROPOSED DIVERSION OF FOOTPATH SHE/1072 AT MILLHOUSES, SHEFFIELD 7.

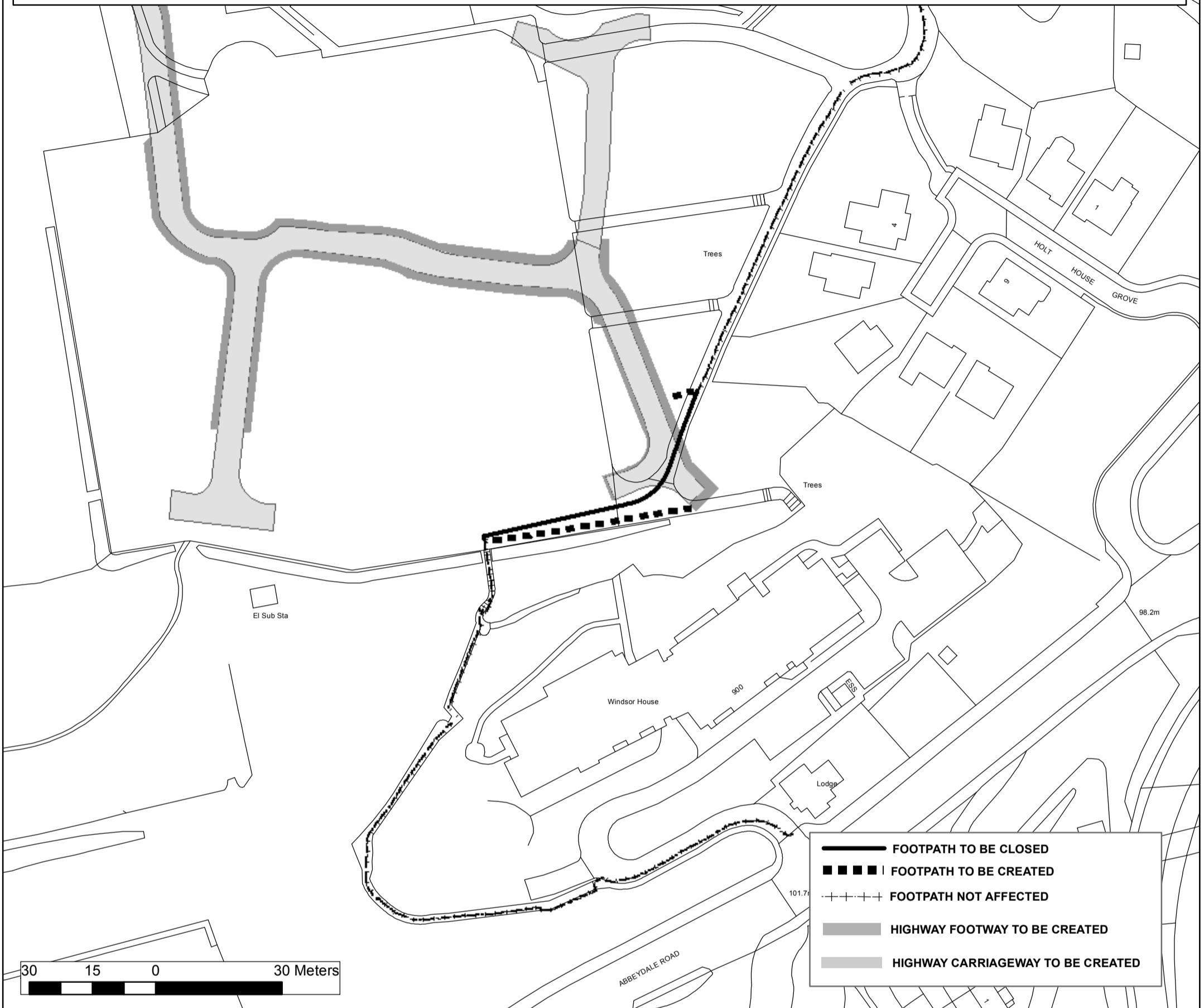

This page is intentionally left blank